

Installation Tips

It must be noted that this transmission mount utilizes Polyurethane bushings, and will add NVH to your driveline.

Be sure to install the mount with the heads of the 1/2" bolts facing the front of the car.

In some instances, it may be necessary to clearance this aluminum boss on the Crossmember so that the mount sits perfectly flush. Set mount on Crossmember before install to double check.

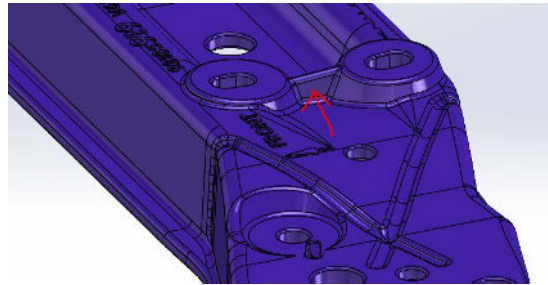

Installation Steps:

1. Make sure your car and transmission are adequately supported.
2. Remove the exhaust system to gain access to Crossmember.
3. Remove the Crossmember.
4. Remove the transmission mount from the transmission.
5. Install new mount to transmission, utilizing factory hardware.
 - a. Torque to 18 lbs/ft
6. Remove nuts on M8 studs and install factory Crossmember.
 - a. Install nuts and torque to 25 lbs/ft
7. Install Crossmember bolts to body.
8. Make sure there are no clearance issues with new mount.
9. Reinstall exhaust system.

It must be noted that this product is sold for “offroad use only” and customer assumes all risks.